

SKID PLATE SUZUKI RMZ 250

SOTTOMOTORE SUZUKI RMZ 250

ACERBIS®

ACERBIS PARTS

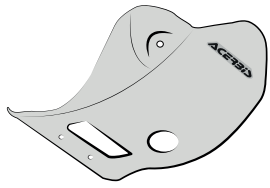

A (1 pcs)

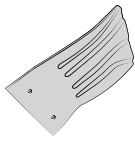

B (1 pcs)



C (2 pcs)



D (2 pcs)



E (2 pcs)



F (2 pcs)

COD. 500006116

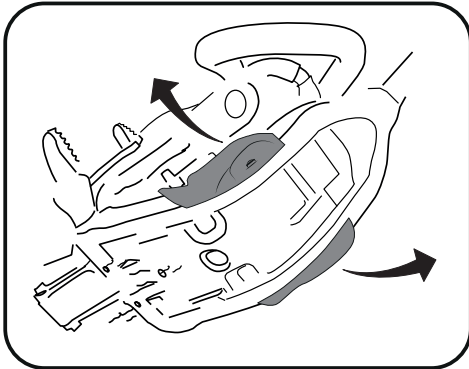

1 - Remove the original water pump and ignition plates/guards.

1 - Smontare le protezioni originali.

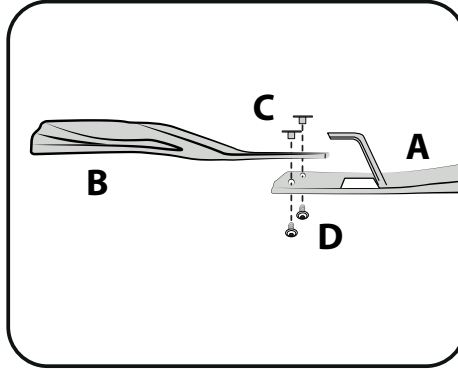

2 - Assemble the linkage guard (B) to the skid plate (A) using the (C) washers and the (D) bolts.

2 - Montare la pinna (B) utilizzando le staffe (C) e le viti (D).

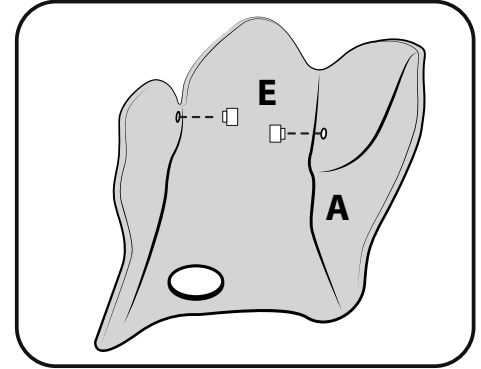

3 - Insert the (E) inserts into the inside holes of the skid plate.

3 - Inserire le boccole (E) nei fori.

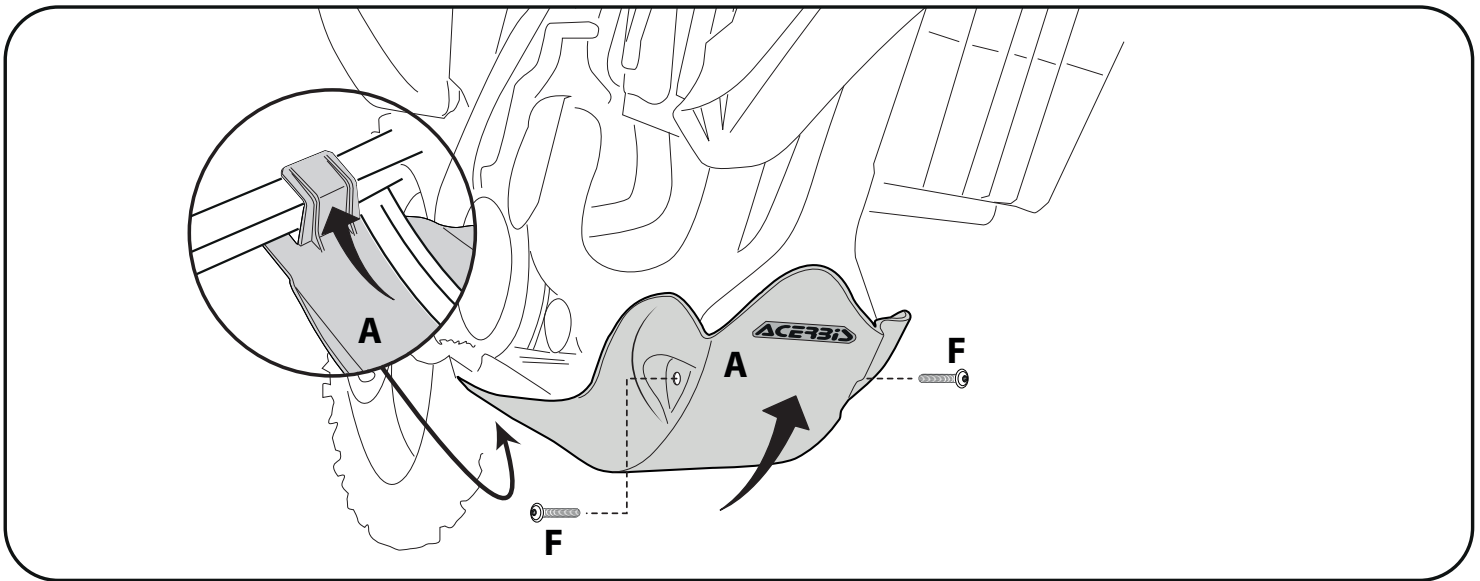

4 - Install the plate by hooking the rear tab to the frame and then press the front of the plate up around the frame. Insert the (F) bolts and secure them tightly.

4 - Inserire il gancio del sottomotore (A) nel telaio. Spingere il sottomotore (A) contro il telaio, quindi bloccarlo con le viti (F).

WARNING!

Use at your own risk. Check the security of your device before you ride. Be sure that you follow the instructions installing the Acerbis products. Do not ride if there is missing or damaged hardware. If this is the case, take the item immediately back to your dealer. Make sure the throttle and other controls are free every time you ride. Lack of attention to instruction and warning could lead to interference with the controls, loss of control, and an accidents. Acerbis recommends that installation must be done by a licensed mechanic and that only Acerbis is original parts are used during fitting. Acerbis makes no guarantees or representations, express or implied, regarding the fitness of its products for any particular purpose. Acerbis makes no guarantees or representations, express or implied, regarding the extent to which its product protect individuals or property from injury or death or damage.